

Thomas Hunter Project Space

930, Lexington Avenue, NYC, NY 10065

The Thomas Hunter Project Space is located at the corner of Lexington Avenue and 68th Street on the lower level. The Number 6 Subway stop entitled "68th Street, Hunter College" is located directly on the corner of the Thomas Hunter Building

Madhvi Subrahmanian

walk and chew gum...

Works in Clay Paper and Video

Curated by Jeffrey Mongrain

Preview: Friday| March 6th | 2020 | 6 to 8pm

On view from March 3rd to March 23rd, 2020

The Thomas Hunter Project Space in New York City is honored to present a solo exhibition by the established Indian artist Madhvi Subrahmanian, entitled '**walk and chew gum...**'. Her one-person show is scheduled from March 3rd to 23rd, 2020. Madhvi's exhibition will in part be large scaled photographic documentation of sited public artworks she created in various New York City neighborhoods during her Visiting Artist Residency at the Hunter College Department of Art and Art History.

Madhvi has a strong interest in public engagement. Some of these public situated works are drawn directly on NY sidewalks and visually appear to be both topographic and gestural. These site-specific drawings accentuate the gum marks discarded by people walking the streets of New York. Madhvi borrows from her cultural context, using rice flour to make Kolams-like patterns, juxtaposing the gridded lines with the abstract black dots created by the gum on these walkways. Kolam is a ritualistic form of painting using rice flour in South India, often created on the streets to welcome the dawn of a new day or a specific auspicious occasion.

The sculptures, ink drawings, video and photographic documentation that will be exhibited are linear versions of architectonic forms. Other works created by Madhvi during her Residency include abstracted window like forms that are directly informed by her ink drawings on paper and vice versa. When installed the shadows cast by these dimensional linear window forms give a visual suggestion of vibration and kinetic energy.

Madhvi states, "As I was exploring the grid and responding to the city in clay, paper and photo documentation, I became fascinated with the organic gum as a persistent mark left behind on the pavement by the people of the city. The marks tell a story of where people congregate, connect, and depart, while disclosing in their movements the social structure of a neighborhood. These gum marks have been on the streets for decades blending into the city, often un-noticed and overlooked by most people. Interestingly some New Yorkers are embarrassed by the gum marks. Today with changing trends, environment consciousness fewer people seem to be chewing gum and disposing it off more responsibly. With new pavements these marks are soon disappearing as the city gets a "cleaner" look. Having lived in Singapore for the last decade where gum chewing is banned these marks become more evident and interesting to me as they narrate the movement of people in the city and mark the spaces where they take a break from its relentless energy."

Jeffrey Mongrain, Distinguished Professor, Department of Art and Art History, Hunter College, New York City.



About the Artist:

Based between Mumbai and Singapore, Madhvi Subrahmanian is an artist, curator, and writer. Her initial training was with Ray Meeker and Deborah Smith at the Golden Bridge Pottery in Pondicherry, India and she has a Masters in Fine Arts from Meadows School of the Arts, Dallas, TX. She is a founder member of the Indian Ceramic Triennale and a member of International Academy Of Ceramics, Geneva and Artaxis, USA. Madhvi has shown in several recent beinnales such as the Central China Ceramic Beinnale at Henan Museum, China and the Korea Ceramic Beinnale in Icheon. Madhvi's works have been published in international magazines, like Art India, Ceramic Art and Perception, Nueve Keramik, Revista Ceramica and in books like Smoke firing by Jane Perryman and Contemporary Ceramics by Emmanuel Cooper. Her work can be seen in numerous public collections such as The Mumbai Domestic Airport, India, The Shigaraki Ceramic Sculpture Park, Japan, The Fule Museum, Fuping China and the Indian Heritage Centre (Singapore Museum), Singapore.

For images and information contact the artist at:

madhvi@madhvisubrahmanian.com

www.madhvisubrahmanian.com



Site-specific installation, stoneware, polymer clay, light and shadow.

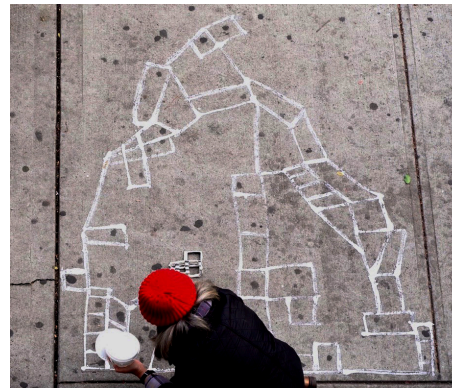

Art intervention in Bushwick, NY
Rice Flour drawing

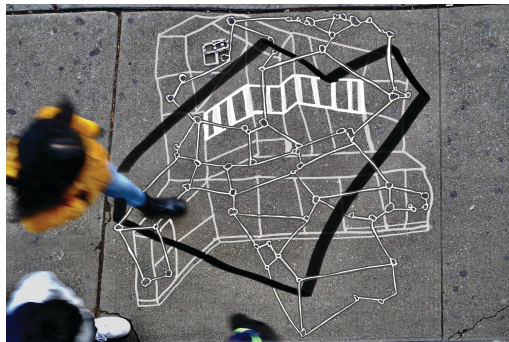

Walk and Chew Gum: C-Print 30" x20' still from video

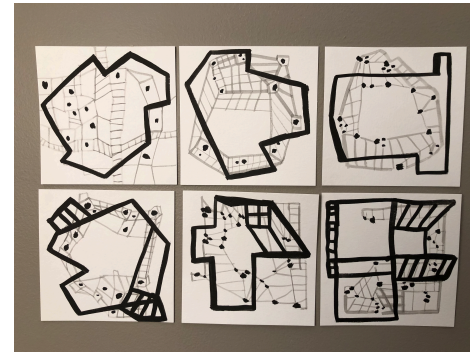

Untitled: Ink on paper drawings 6" x6"